

Llucmajor

Reference 122043



PORTA MALLORQUINA®
Your home. Our passion.

Building plot with equestrian complex and buildings in beautiful surroundings in Galdent near Llucmajor

plot area:	20.290 m ²	water:	-
sea view:	-		
dev. Potential:	394 m ²		
building permit:	-		
electricity:	-	price:	€ 585,000.-



Llucmajor

Reference 122043



Details:

This large building plot is located right on the outskirts of Llucmajor in the popular area of Galdent, at the foot of the Hexenberg and offering beautiful mountain views

With an area of approx. 20,290 sqm the plot is easily accessible via a wide tarred road. A building project was submitted 2 years ago for the construction of a beautiful, Mediterranean-style finca with a total constructed area of 394.36 sqm and a living area of 297.22 sqm.

There is also a pending project for the construction of a building containing 3 horse stables with shelters, porches, hay storage and tractor garage. Already in existence there are several fenced training areas, paddocks, shelters, etc.

Water supply is assured by a well project, with the electricity currently generated by a photovoltaic system which can later be connected to mains electricity including the house.

Llucmajor

Reference 122043



Location & surrounding area:

In terms of surface area, Llucmajor is the largest municipal county on the island of Majorca and is located in the south. Its population amounts to 20,000 inhabitants.

The small city includes 4 supermarkets, some well loved cafés and tapa-bars, and even a thrice-weekly fruit and vegetable market, taking place in the very recently renovated town centre, with its Plaza de España and the second largest church on the island.

The picturesque hill-location of Randa on the mountain of the same name, which is the most elevated point in the island's centre, houses three sanctuaries, and is located slightly north of the town. Llucmajor has developed into an economic and popular residential location, due to the new motor-way connection to Palma. The Marriott Son Antem Golf Resort and Spa, and nearby yacht clubs make Llucmajor an interesting and central location for planning pass-times and excursions.

The Es Trenc natural beach, one of the nicest on the island and with a Caribbean similarity, lies just 15 car minutes from Llucmajor.

Llucmajor
Reference 122043



Building



Garden



Plot



Plot



Plot



Plot

All information is correct to the best of our knowledge. Errors and prior sale excepted. This prospectus is purely for information purposes. Only the notarized deed of sale is legally binding.

Llucmajor
Reference 122043



Plot



Plot



Plot



Plot



Plot



Plot

All information is correct to the best of our knowledge. Errors and prior sale excepted. This prospectus is purely for information purposes. Only the notarized deed of sale is legally binding.

Llucmajor

Reference 122043



PORTA MALLORQUINA®
Your home. Our passion.



Plot



AUDIO VISION



Plan



AUDIO VISION



Plan

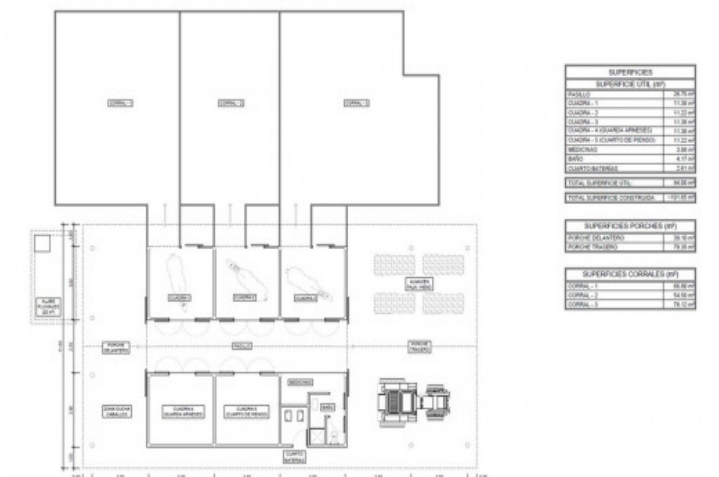

Plan



Floor plan

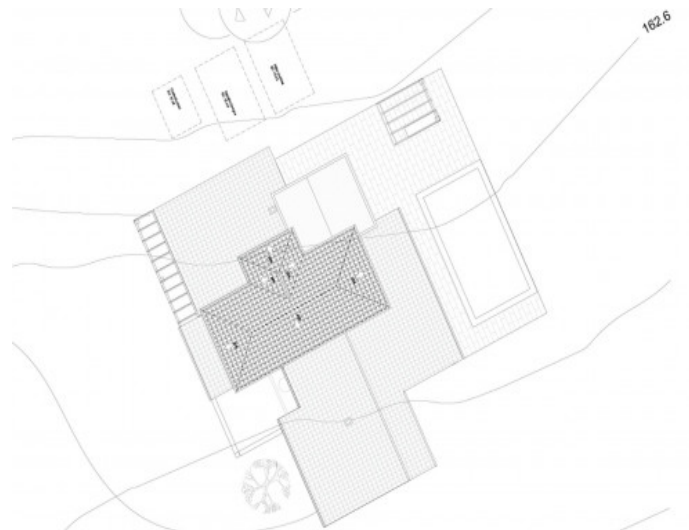

Plan

All information is correct to the best of our knowledge. Errors and prior sale excepted. This prospectus is purely for information purposes. Only the notarized deed of sale is legally binding.

Llucmajor

Reference 122043



PORTA MALLORQUINA®
Your home. Our passion.

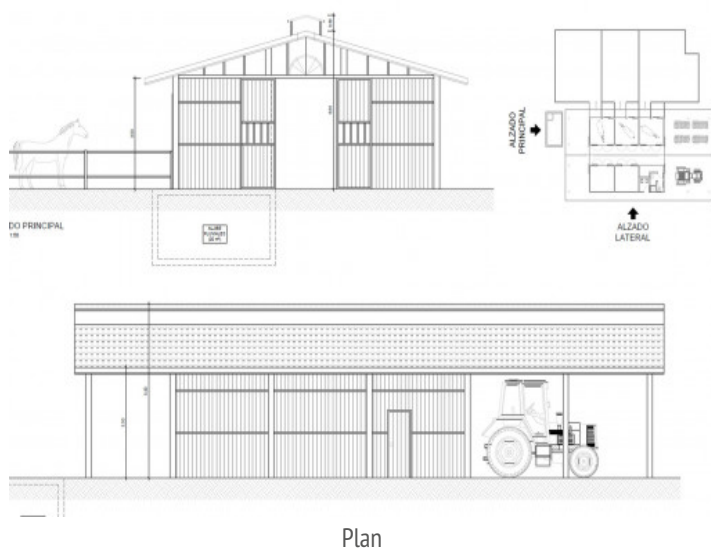

All information is correct to the best of our knowledge. Errors and prior sale excepted. This prospectus is purely for information purposes. Only the notarized deed of sale is legally binding.

PORTA MALLORQUINA • C./ CONQUISTADOR 8, 07001 PALMA
TEL. +34 971 698 242 • INFO@PORTAMALLORQUINA.COM