

Portixol
Reference 120064B



Innovative luxury penthouse with private roof terrace and underground parking in Nou Llevant

constructed area:	210 m ²	swimming pool:	✓
bedrooms:	3	energy certificate:	in process
bathrooms:	2		
balcony/terrace:	✓		
sea view:	-	price:	€ 1,840,000.-



Portixol

Reference 120064B



Details:

In Nou Llevant, near Portixol, overlooking the lively and elegant district and within walking distance of the port, a unique and spectacular construction project with 65 units is currently under construction. Here, people who love something special will find a home that is impressive in many respects. Each apartment in this project is absolutely unique and impresses with the highest construction quality, innovative design, modern technology and forward-looking sustainability.

This project focuses on the development of holistic, future-oriented and innovative living concepts that are special due to their architecture and design. Unique floor plans are created by integrating the latest design trends and the highest quality materials.

The penthouse is located on the third floor and extends over a generous constructed area of 209.77 sqm, offering 3 bedrooms and 2 bathrooms, one of which is en suite. There is also a separate guest toilet. An absolute highlight is the private roof terrace with a generous area of 67.76 sqm, which offers you plenty of space to relax and enjoy.

Extra features include air conditioning, underfloor heating, electric blinds and motorized windows, smart home, CCTV - CCTV system, energy-efficient lighting and a storage room.

The community area includes a lounge, an infinity pool, a gym, spa rooms, concierge service, a cinema room and a golf simulator.

An underground parking space with electric charging station can be purchased on request, as well as extra storage rooms.

Portixol

Reference 120064B



Location & surrounding area:

Portixol/Molinar is one of Palma's loveliest and most popular zones, both as a holiday destination and for real estate buyers.

Portixol is an old fishing harbour which has become one of the most popular areas of Palma, and its name means 'Harbour and Sun' in Mallorquin. It has excellent fish restaurants, great tapas bars and diverse cafes filled with life all year round and leaving no gastronomical wishes unfulfilled. Many are situated right on the sea with views of the small beach and the Club Nautic in Portixol. Sports enthusiasts such as cyclists, inline-skaters and walkers love the Paseo Maritimo which leads to Palma without gaps or interruptions, and the zone is completed by its many and varied shops and supermarkets and the large, modern sports centre.

Beach fans will also feel at home in the district of Portixol/Molinar. Both on Palma's town-beach Portixol with its very clean water but also in the small charming bays which can be found on the way from Molinar to Palma.

Portixol
Reference 120064B



Inviting pool area



Alternative view



Bright living area



Living area with terrace access



Open kitchen



Cosy terrace

All information is correct to the best of our knowledge. Errors and prior sale excepted. This prospectus is purely for information purposes. Only the notarized deed of sale is legally binding.

Portixol
Reference 120064B



Terrace with bathtub



Pool area



Golfsimulator



Massage

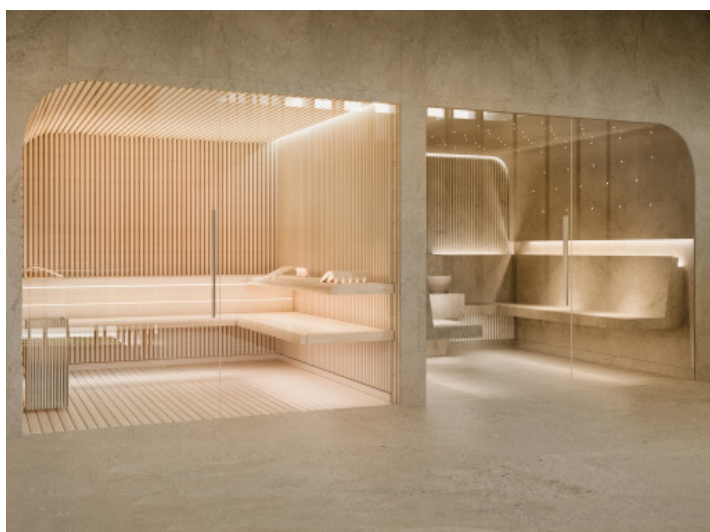

Sauna



Beautifully planted communal area

All information is correct to the best of our knowledge. Errors and prior sale excepted. This prospectus is purely for information purposes. Only the notarized deed of sale is legally binding.

Portixol
Reference 120064B



New luxury apartment with park area in Nou Llevant



Access to the complex



Plan



Plan

All information is correct to the best of our knowledge. Errors and prior sale excepted. This prospectus is purely for information purposes. Only the notarized deed of sale is legally binding.