

Bonanova
Reference 116632C



Palma Sea View - Luxury residential project with highest standards duplex, garden & pool

constructed area:	120 m ²	swimming pool:	✓
bedrooms:	3	energy certificate:	in process
bathrooms:	2		
balcony/terrace:	✓		
sea view:	✓	price:	€ 760,000.-



Bonanova

Reference 116632C

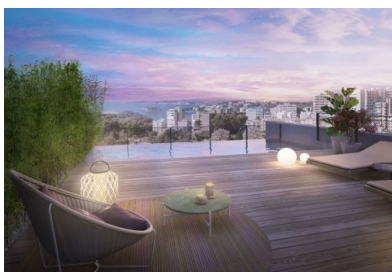

Details:

Parallel East & West' presents itself with 2 innovative buildings, each with 6 luxury flats, which optionally have a private swimming pool, their own garden or a protected roof terrace with panoramic views over the bay of Palma, Cala Major and Illetas.

Architectural aesthetics, contemporary, respectful sustainability, highest energy efficiency as well as a harmonious embedding in the natural environment have been combined at an outstanding level in this special residential project.

The building ensemble is located between the polarities of "Panorama Palma Bay" and "Bellver Castle".

This oasis of well-being on 2 levels has a total area of 120 sqm, distributed in 2 bedrooms on the second floor, a bathroom, a bedroom with bathroom en suite and a utility room. On this floor you can enjoy the panoramic view of Palma.

On the first floor there is a guest toilet in the entrée. Attached to the kitchen and living area is an integrating terrace and the garden area of 48 sqm with pool.

There is also a fully equipped air-conditioned fitness area.

A garage spaces with storage room is included in the purchase price.

Orientation: E/W

The property is already under construction and is expected to be completed in October 2021.

Bonanova

Reference 116632C

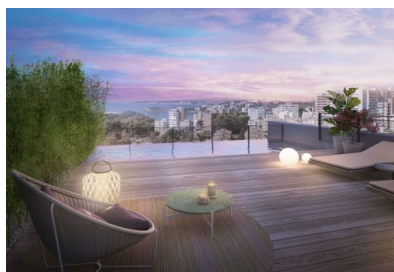

Location & surrounding area:

Due to its elevated location, bordering with the wonderful Parc de Bellver with the famous Bellver castle, the beautiful area of Bonanova provides wonderful views over the whole of the bay of Palma, the open sea and the mountains.

This villa district, although centrally located and with superb connections to the centre of Palma by car or bus, is one of the quietest and most secure districts of Palma. It offers, therefore, the possibility to live in a peaceful area but still be able to easily enjoy all the facilities of the town with its restaurants, bars, cafes and shops.

In addition this neighbourhood itself offers exquisite gastronomy, supermarkets, sports locations and clinics, all close by. The shopping centre of Porto Pi, for example, is only a few minutes away by car and offers a huge choice of shops and restaurants. Lovely beaches such as that in Cala Major are also only a few minutes away by car. Bonanova, furthermore, is also ideal for children with the 'Queen's College' which enjoys an excellent reputation internationally.

Bonanova
Reference 116632C



Iconic newly built apartment complex in Palma



Exterior view of the complex



Fully equipped kitchen with cooking island



Noble bathroom en suite with walk-in shower



Exterior view of the complex



Airconditioned fitness area

All information is correct to the best of our knowledge. Errors and prior sale excepted. This prospectus is purely for information purposes. Only the notarized deed of sale is legally binding.

Bonanova
Reference 116632C



Fully equipped kitchen with cooking island



Spacious double bedroom



Noble bathroom en suite with walk-in shower



Exterior view of the complex



Fitness area with air condition



Exterior view from the street

All information is correct to the best of our knowledge. Errors and prior sale excepted. This prospectus is purely for information purposes. Only the notarized deed of sale is legally binding.